



PROSERVE

Quick Start

(Single Trainee Pack)



CONTENT OF TRAINEE PACK



- The solution contains the following equipment:
 - Last generation laptop
 - WIFI 6E Router
 - 5K VR Headset
 - Weapon Replica + Tracker
 - Wrist Tracker
 - Additional Battery
 - Misc cable, power adaptor

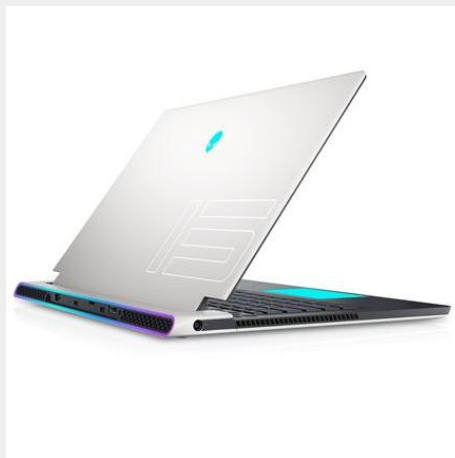



COMMISSIONING



1 - CHARGING VR EQUIPMENT

- Check the battery level of the headphones via a short press of the button on the back of the headphones or the second battery provided. If necessary, recharge the headset battery

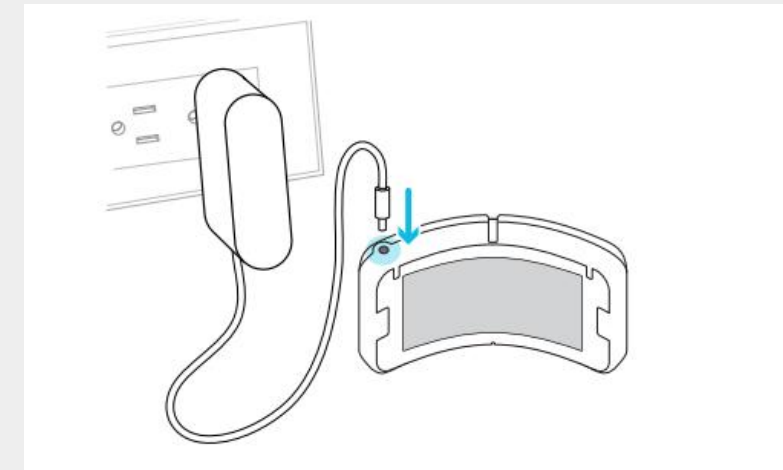
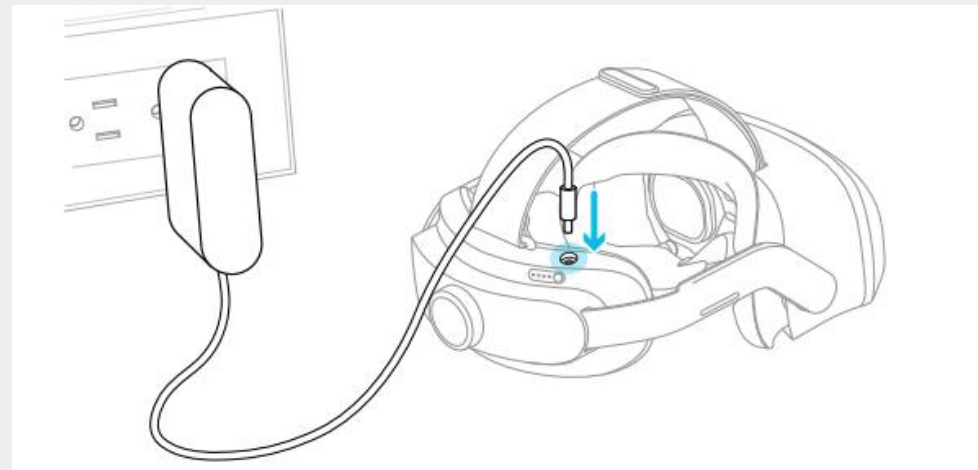
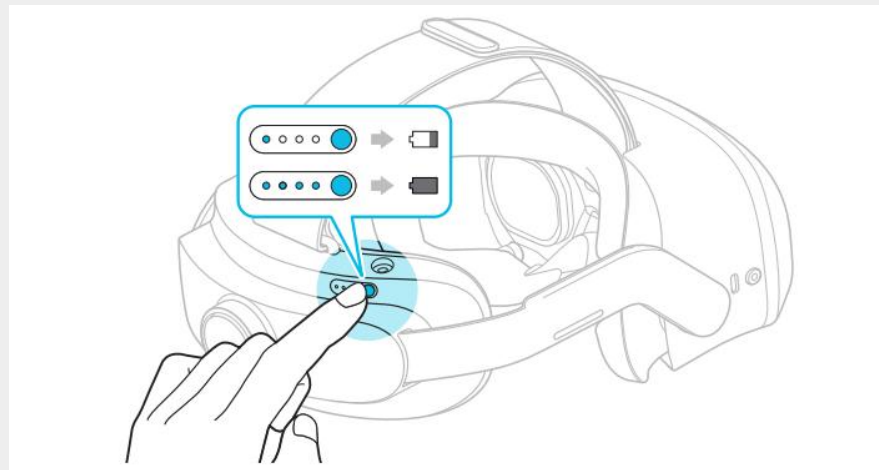

- Check the charge of both trackers via a short press of the button. They should light up solid blue or green, if red or no light they must be charged using a USB-C cable

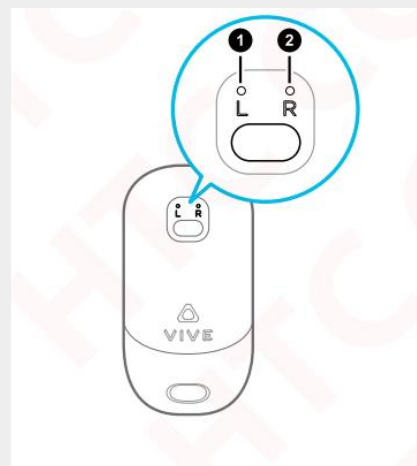

Status	LED behavior
Low battery	Blinks red
Charging	Solid amber
Fully charged	When connected, solid amber to solid green when not connected, solid amber to solid blue
Pairing	Blinks blue
Connecting	Solid blue
Connected	Solid green

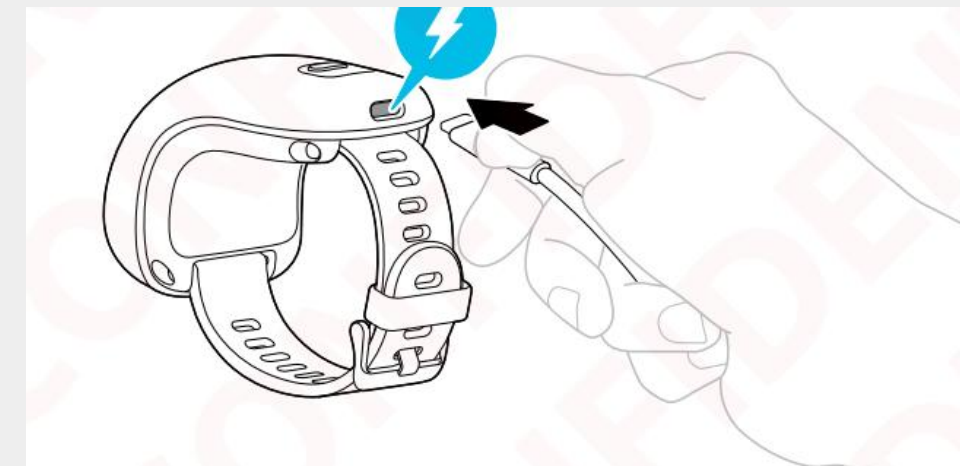

2 - CONNECTION AND IGNITION

- Connect the laptop to the mains via its adapter
- Connect the router to the mains via its adapter
- Connect the Ethernet cable to the router on one side on one of the inputs numbered 1, 2, 3 or 4
- And on the other side on the network socket
- Press the Router power button
- Open the laptop and power on with a press on the "Alien" button for one second, it takes 3-4 seconds to light up and boot up
- Press the Power button of the VR headset long enough, the "Vive Focus 3" Logo should appear on the screen
- Once the helmet is started, briefly press the Power buttons of the two trackers which must switch to green, that of the weapon above the mention R for Right and the wrist tracker on L for Left

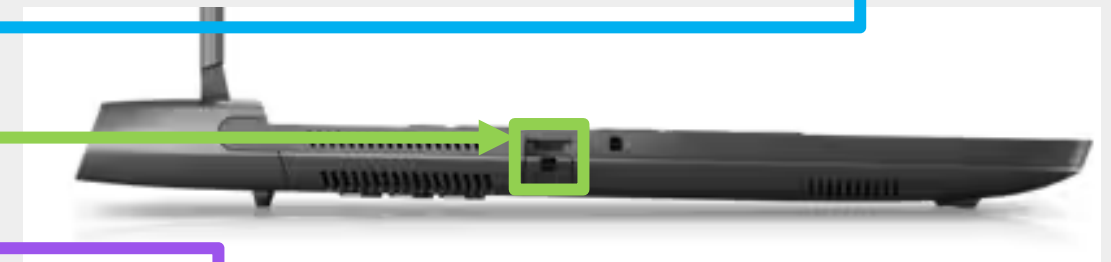

3 - CONNECTION AND PREPARATION



- **Don't launch PROSERVE at this time:** you need to check that VR is Ready in a first step
- **Check that the router is ready:** the LEDs on the fronts must be fixed
- **Initialization of VR headset**
 - Wear the VR headset
 - You should see the Vive logo turning progress on a black background
 - Turn your head slowly in all direction, look the ground even if you can't see it.
 - If you are in front of a table, for example, it could be initializing the headset with a wrong height (see troubleshooting section to fix this)
 - It will take a few seconds, then Vive logo will disappear, and it will reveal a void environment with a grid on the ground and a "Vive Streaming" mention in front of you
 - Then in the helmet you should also see the trackers appear and even see them move if you manipulate them

4 – ADJUST HEADSET



- Adjust vertical position of the headset
- Move headset up and down on your face

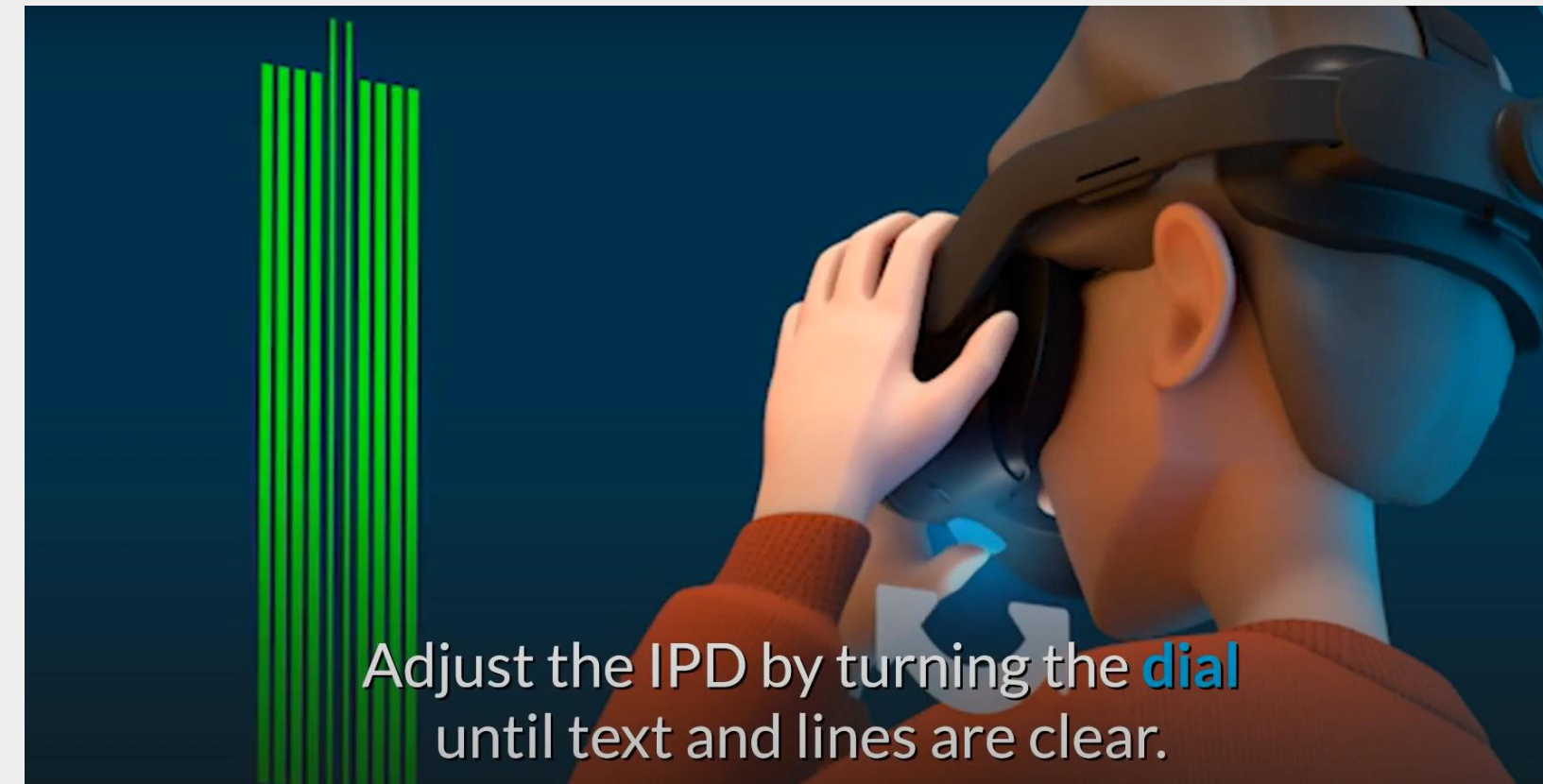

- Adjust horizontal position of the headset
- Moving the dial under the headset will make appear vertical and horizontal lines which help you to adjust headset to your vision

5 - WRIST TRACKER

- Your wrist that is not carrying the weapon must be equipped with the Wrist tracker so that the simulation can animate your second hand. Attach it like a watch around the wrist.
- **You should be able to read the VIVE in the right way**

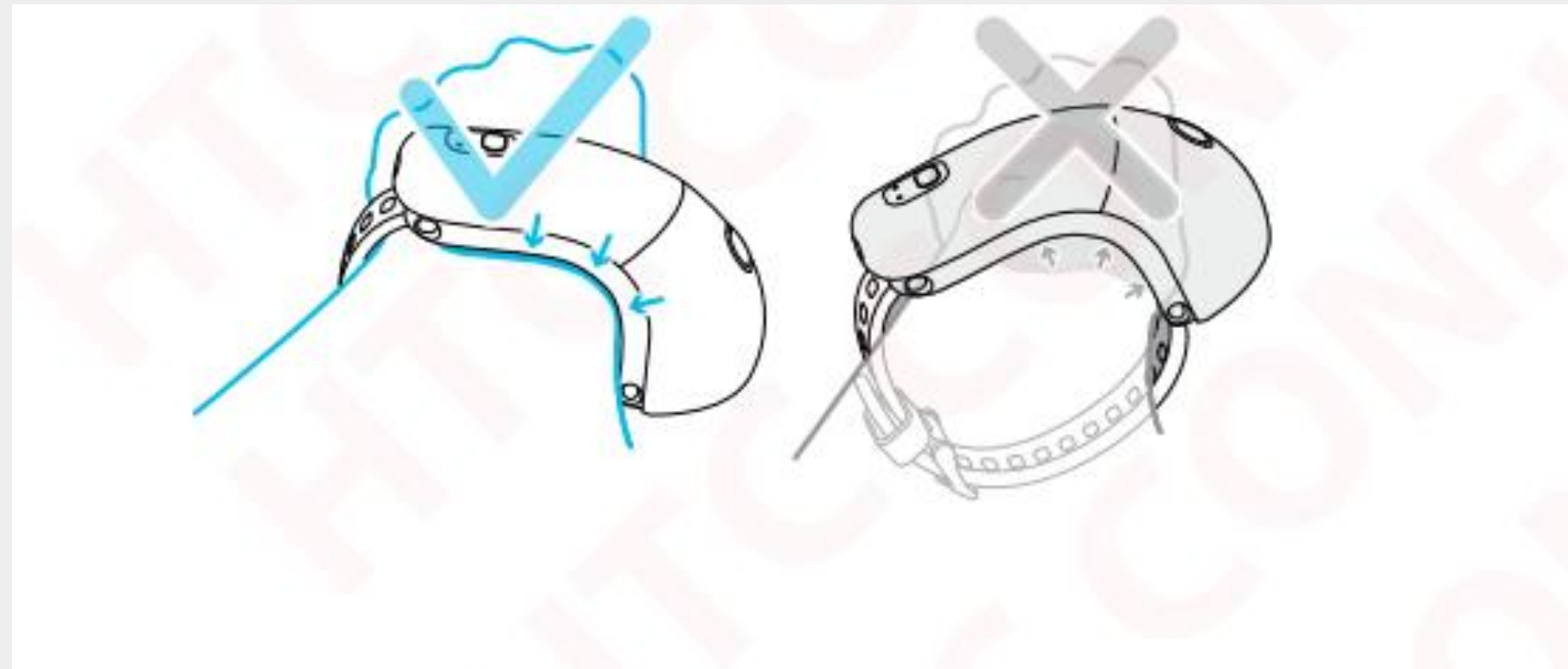
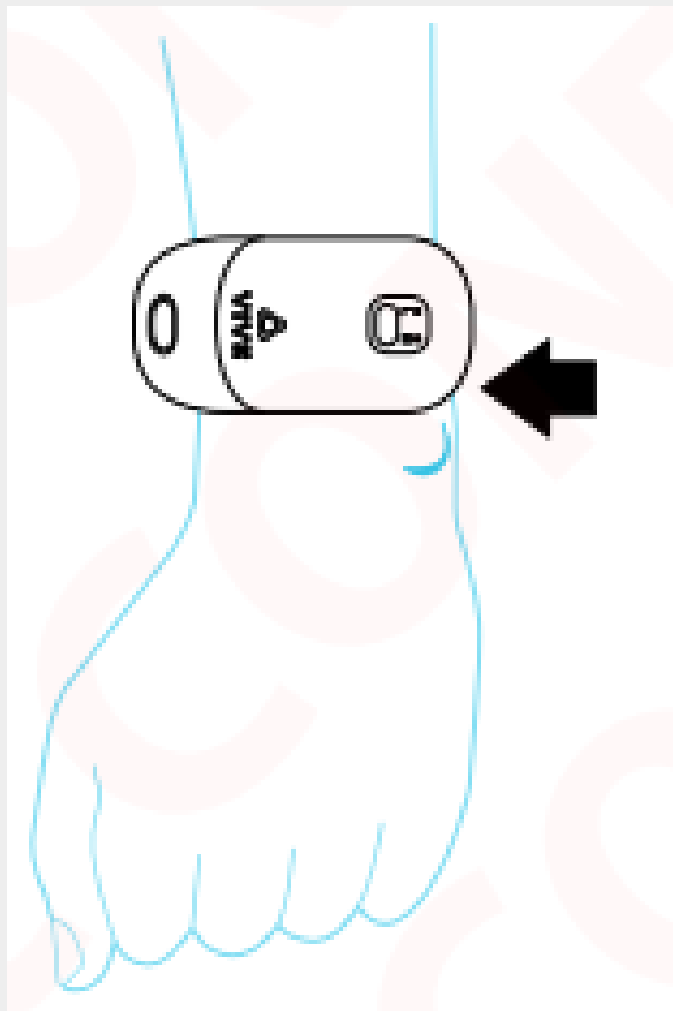

6 – Refill Gaz for your Replica

- Depending of your replica there is two type of gaz needed for blowback
- Procedure for refilling Gaz or change CO2 cartbridge can change dependings of the replica
- There is is many resource videos and tutorial you can easily find on internet

Gaz

Always refill with the Gaz bottle upside-down so that the liquid gaz can go in the charger



Co2

Unfill old cardbridge, unscrew, insert new one, rescrew

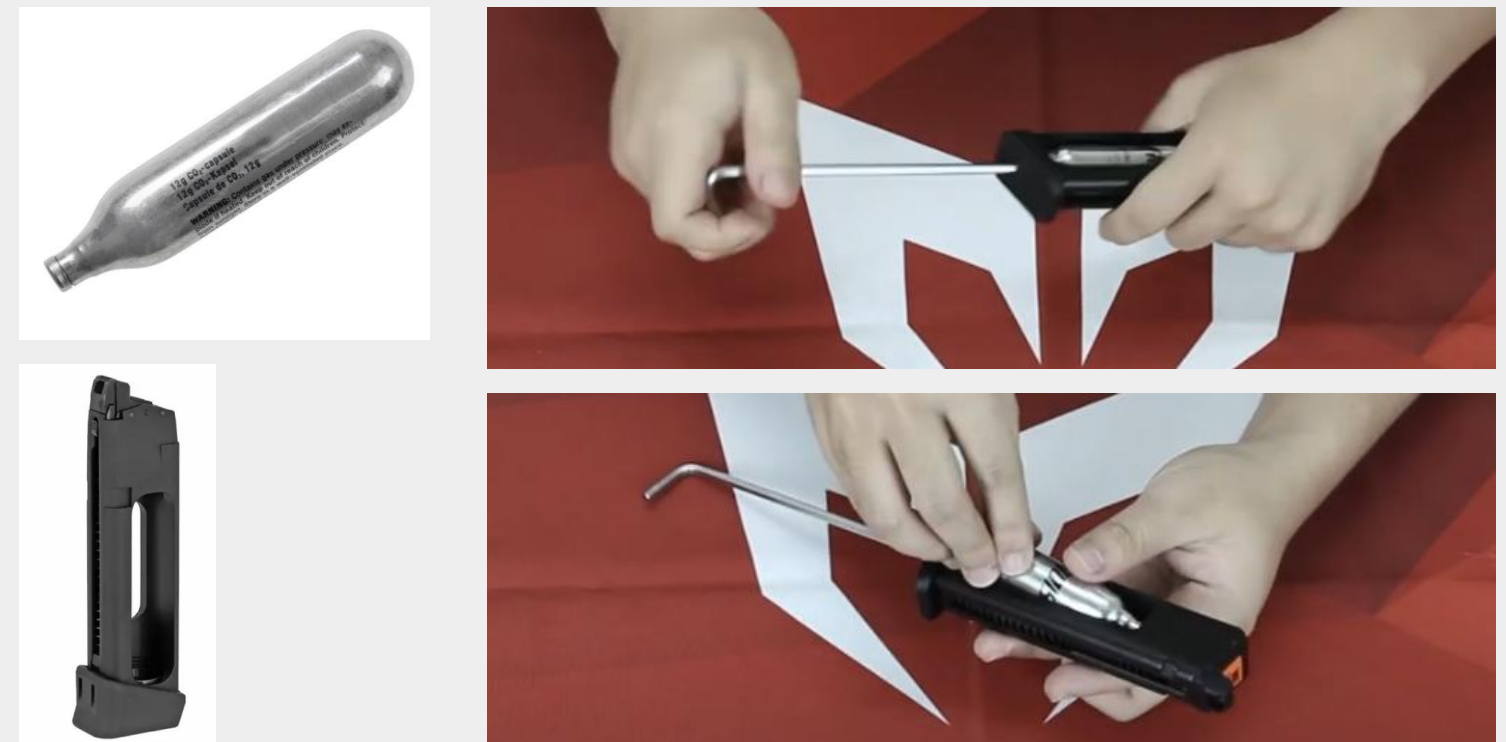

7 – GLOBAL CHECKS



- Before launching PROSERVE, check that you are in the Vive Business Streaming (VBS) environment and that **no error message** appears.
- You should also see the trackers floating at their 3D position
- Check that the 3D ground (represented by a grid) corresponds to the real ground, place the replica on the ground to ensure this, for example
- Otherwise put the headset on standby (double quick press on the rear button), take it off then put it back on again. Look around you while tilting your head slightly downward.
- Remember to turn the trackers back on as well, putting them into standby turns them off
- The proximity of a table can make the headset believe that the floor is at that level

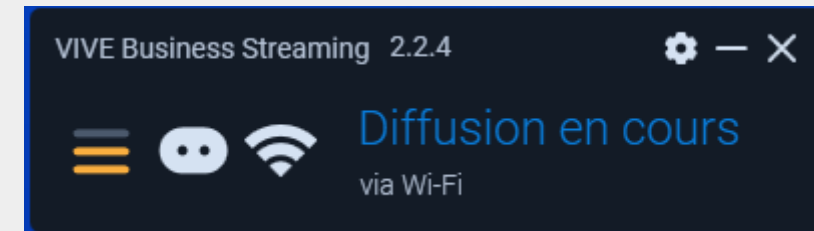

Launch PROSERVE!



USE OF PROSERVE

Single Trainee Pack



LAUNCH PROSERVE



- Double Click on the PROSERVE application icon on the Windows desktop
- The application loads and displays the following screen

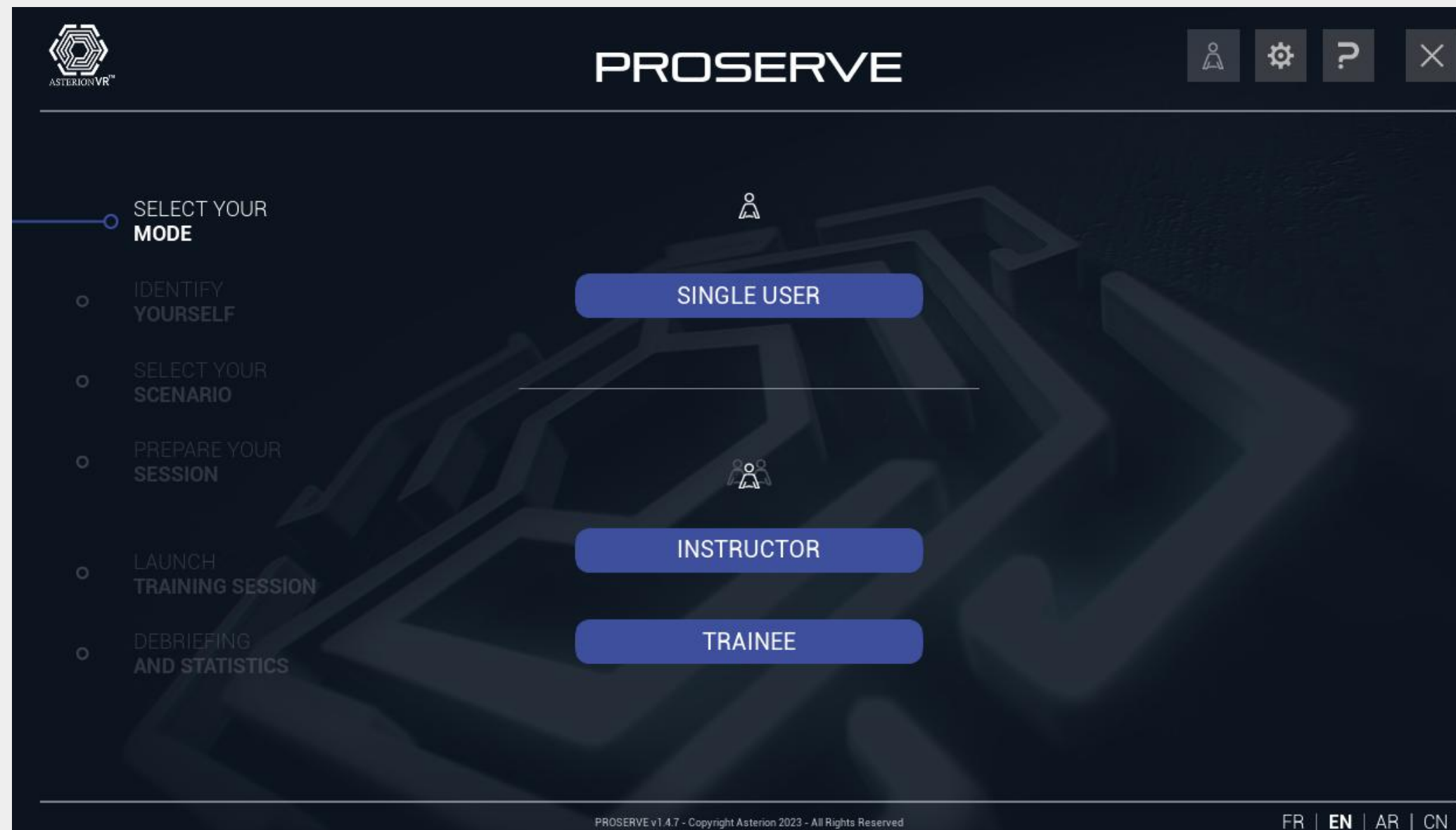

USER IDENTIFICATION



- The next screen will ask you to **log in with your user account**
- If you don't have any account yet, fill in a username and password then click on **"Create User"**
- If you have already created an account before, enter the information and click on **"Sign In"**

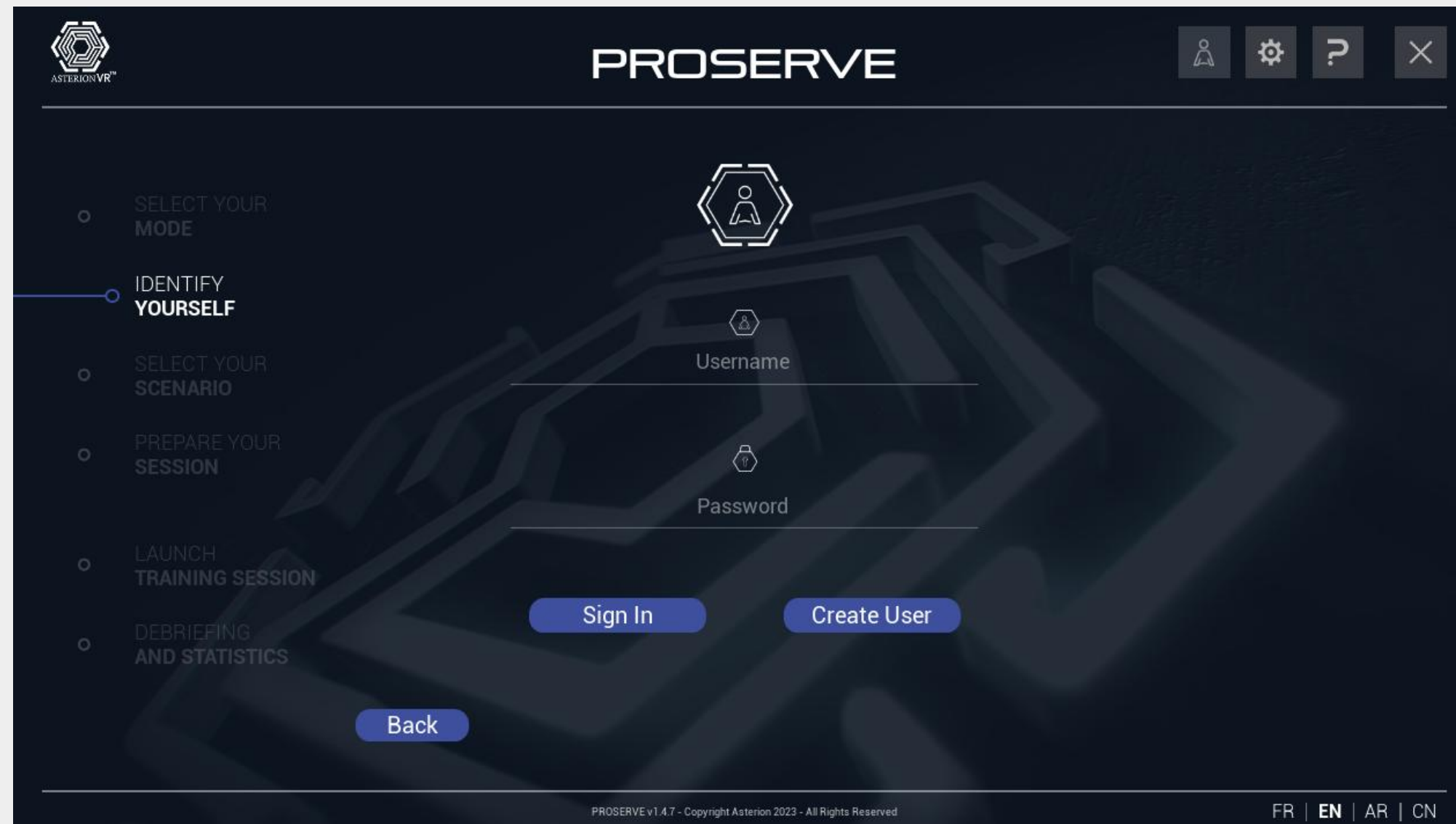

USER SETUP



- Once connected you can access and modify your personal information via this button at the top right
- A new screen opens above the main screen giving you access to your personal information, preferences, statistics and recordings of past sessions

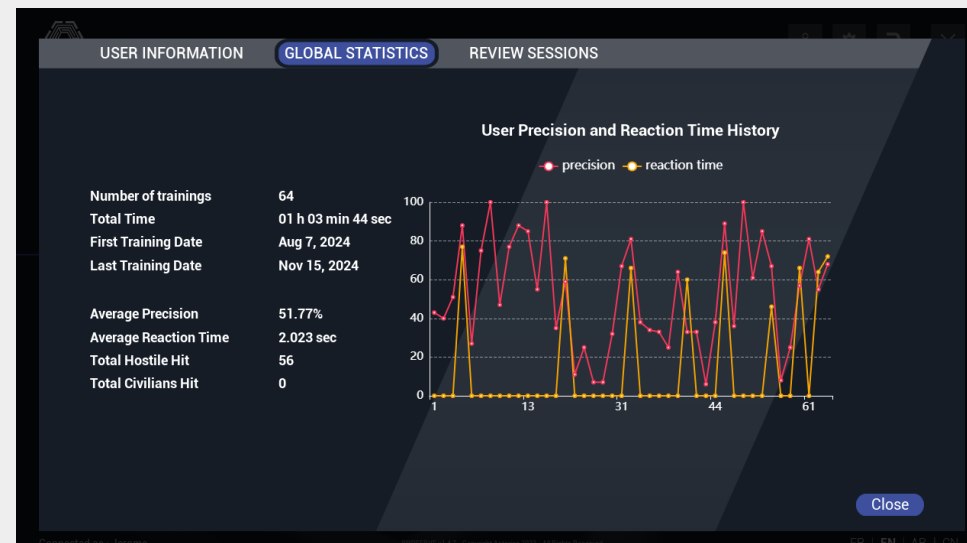
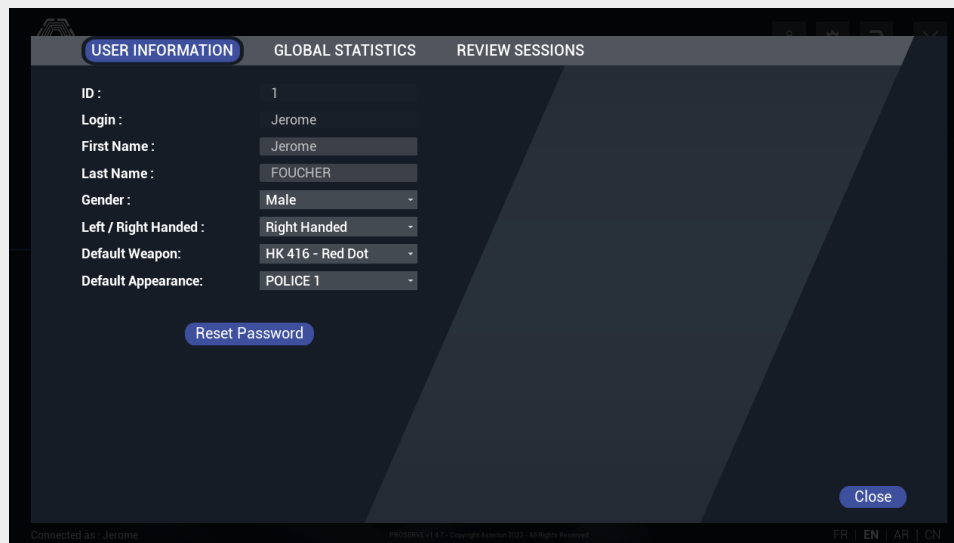

- The backup is performed automatically by closing the window via the close button.



These information are only stored on the PROSERVE system and are not transferred over the internet

CALIBRATION



- Select Calibration
- Press Launch
- Put your headset
- When finish, press Espace key to return to menu

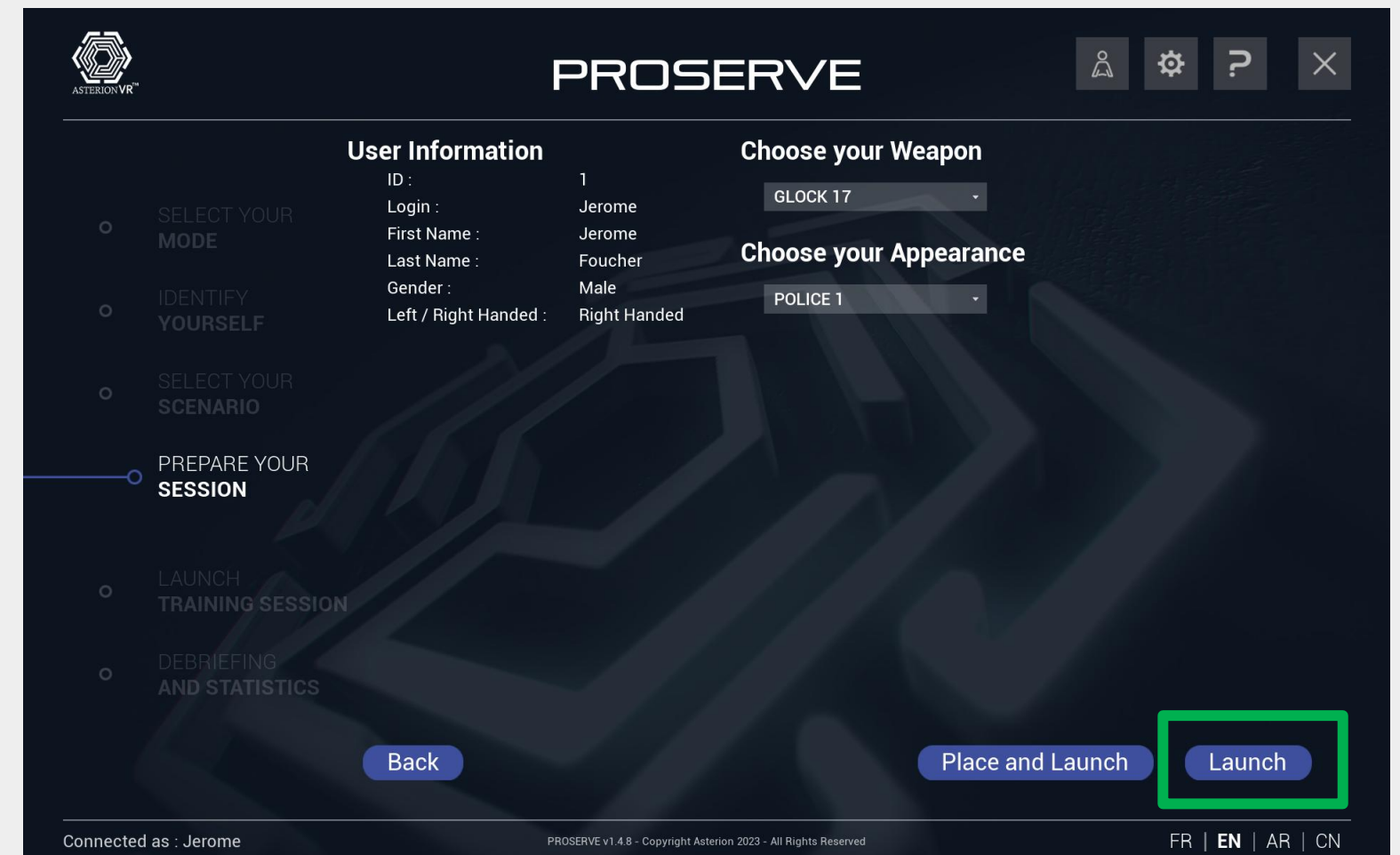
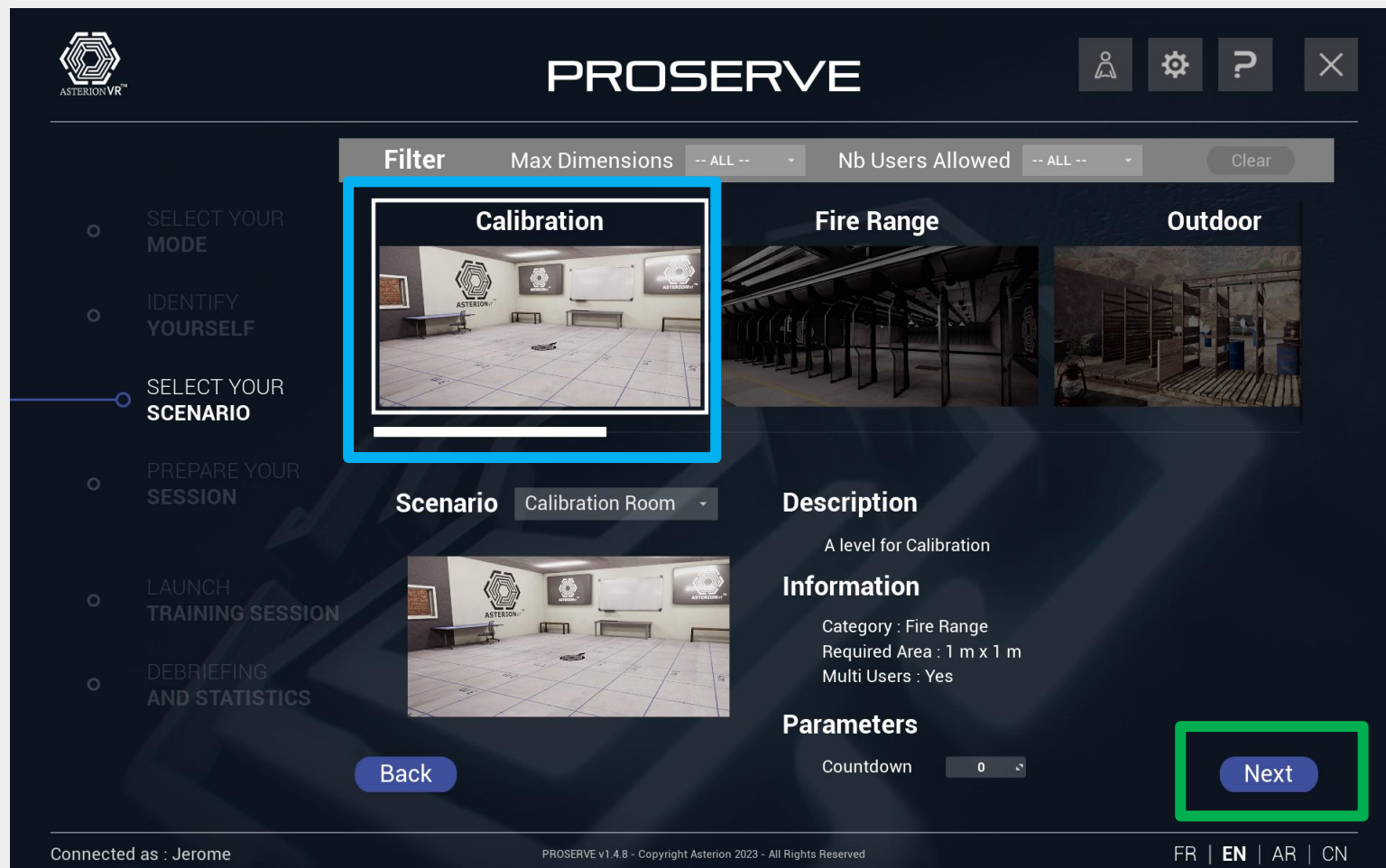

CALIBRATION



- Calibration allows you to adapt your training space to PROSERVE scenarios.
- It's very important to understand that:
 - When you put the headset, center position and orientation will be at the place you stand and look
 - It will not fit your training space, you have to change this center and orientation

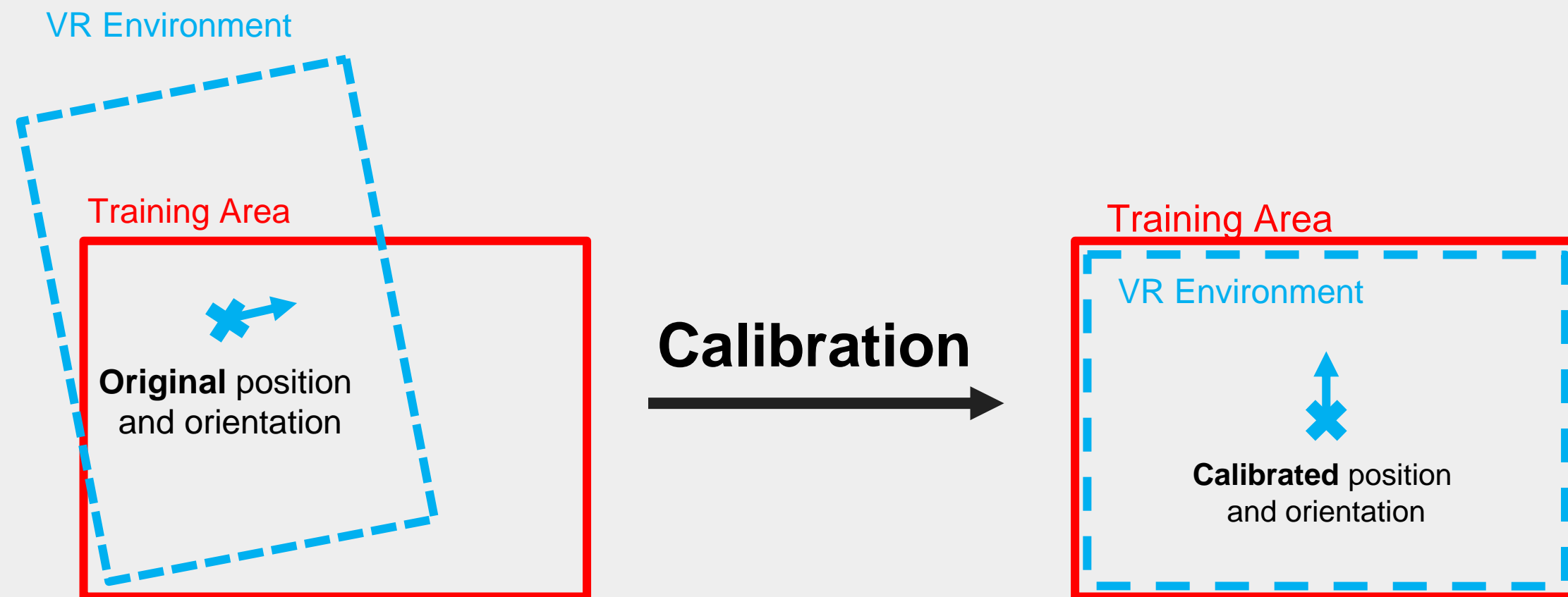

CALIBRATION (SINGLE TRAINEE PACK)



- Launch Calibration scenario
 - Work on any scenario but calibration scenario is suited for this
- Wear the headset
 - You can activate **passthrough** of headset to move without risk of hurting walls
 - Switch VR and Passthrough mode: **Fast double press headset button** at left side
 - If you press not fast enough, it will open a menu, press again to close this menu and retry

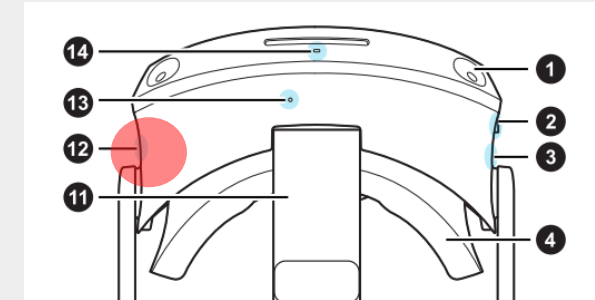

- Long press the App Button of tracker (Gun or Wrist)
 - A message will appear after 3 seconds
 - Message will tell you what to do



Long Press

- Like indicated in the message box:
 - Place yourself at the center of the training Area,
 - Look straight ahead at a wall
 - Short press same button of the tracker



Short Press

SCENARIO CHOICE

- The next screen allows you to choose your **environment** and your **scenario**

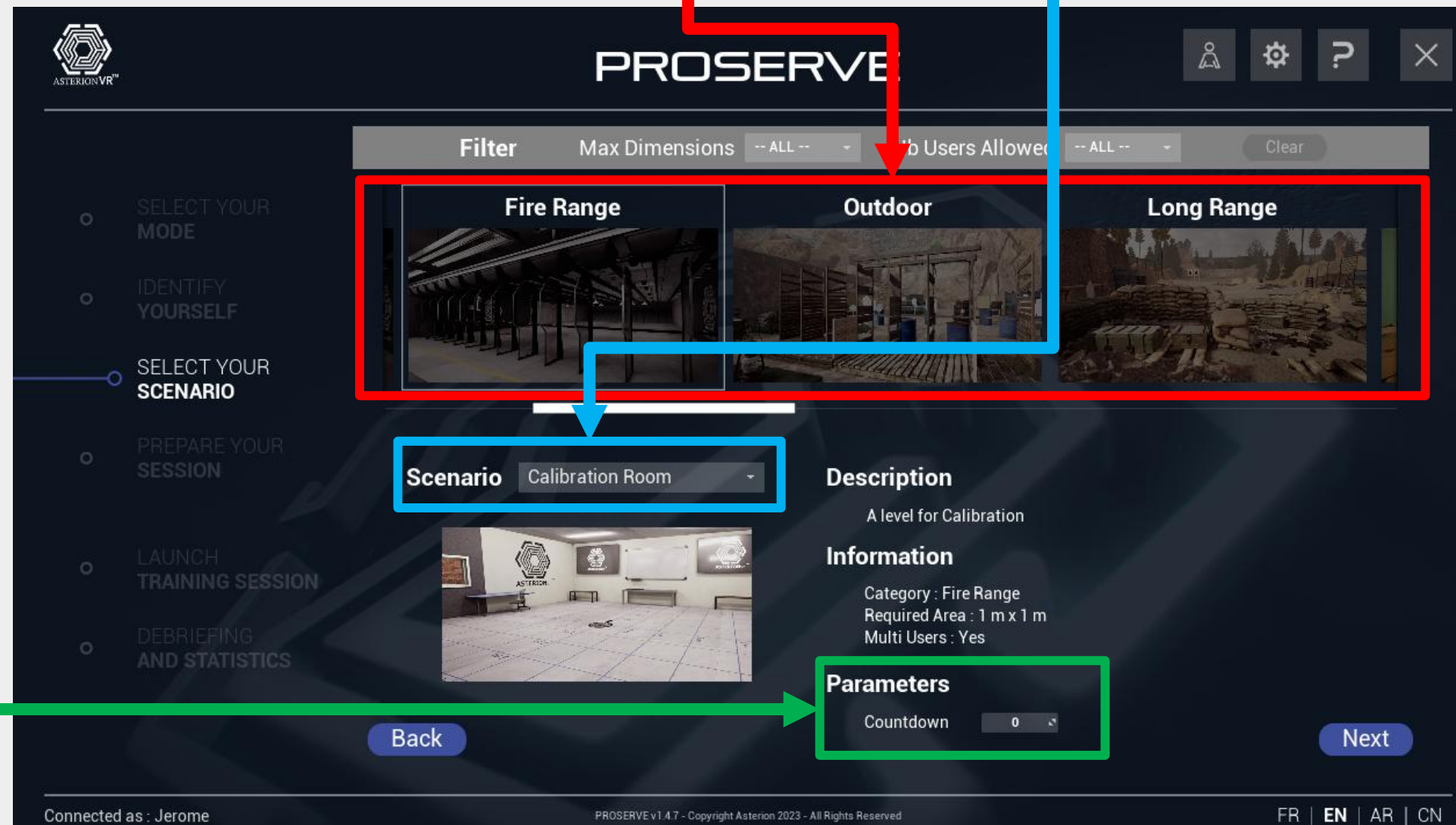

- You can set a **countdown** that will at scenario start

WEAPON AND APPEARANCE CHANGE



- The next screen presents you with a summary and to choose your weapon which must correspond to the one on which the tracker is fixed
- click on the start button to start the training session
- The display switches to virtual reality with a copy on the laptop screen

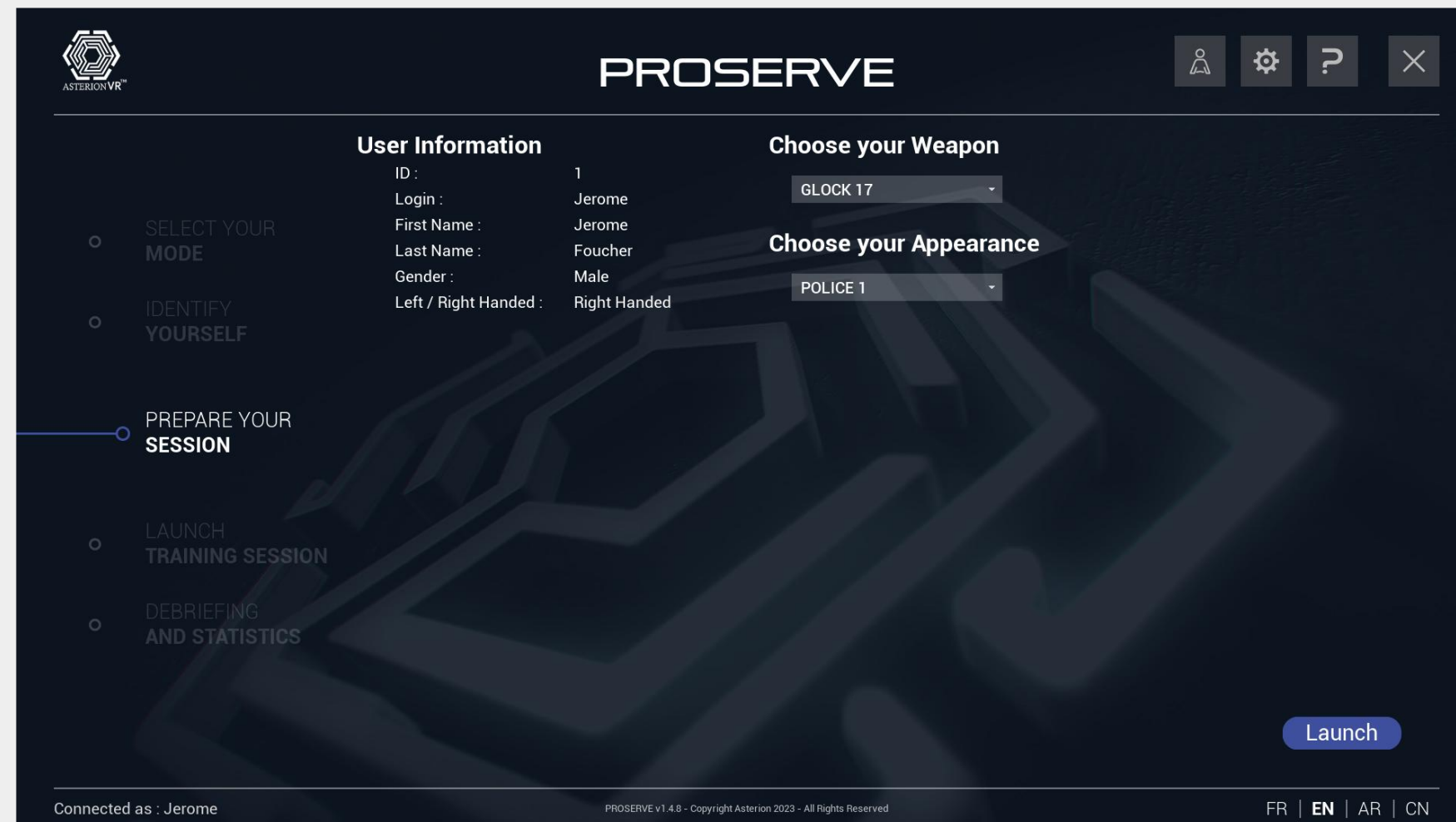

MISSION



- Follow the mission objectives



END OF MISSION



- Depending on the scenarios, you will either be asked to remove your helmet if the objectives are reached or a stopping condition has been caused (death in the simulation for example), or you will make the decision yourself to stop it (free shooting in the shooting range for example will not stop on its own)
- In both cases, take off your headset and press the ESCAPE button on the laptop
- A debriefing screen will then be displayed with the statistics related to the scenario

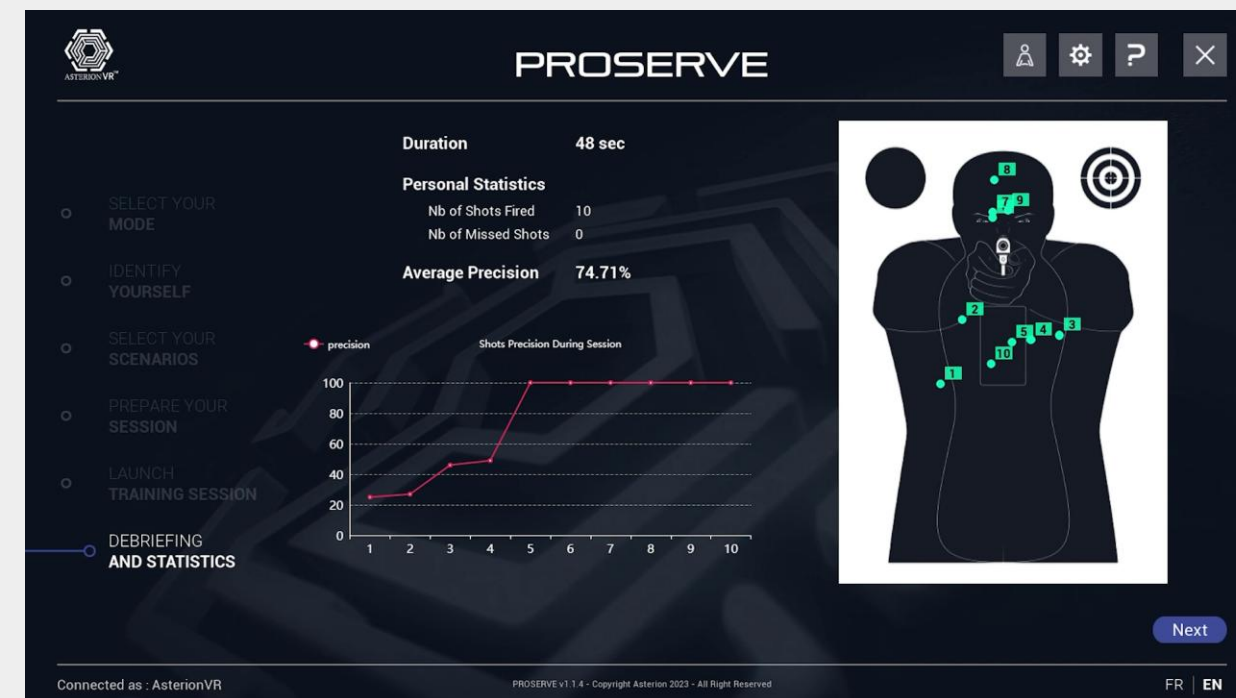
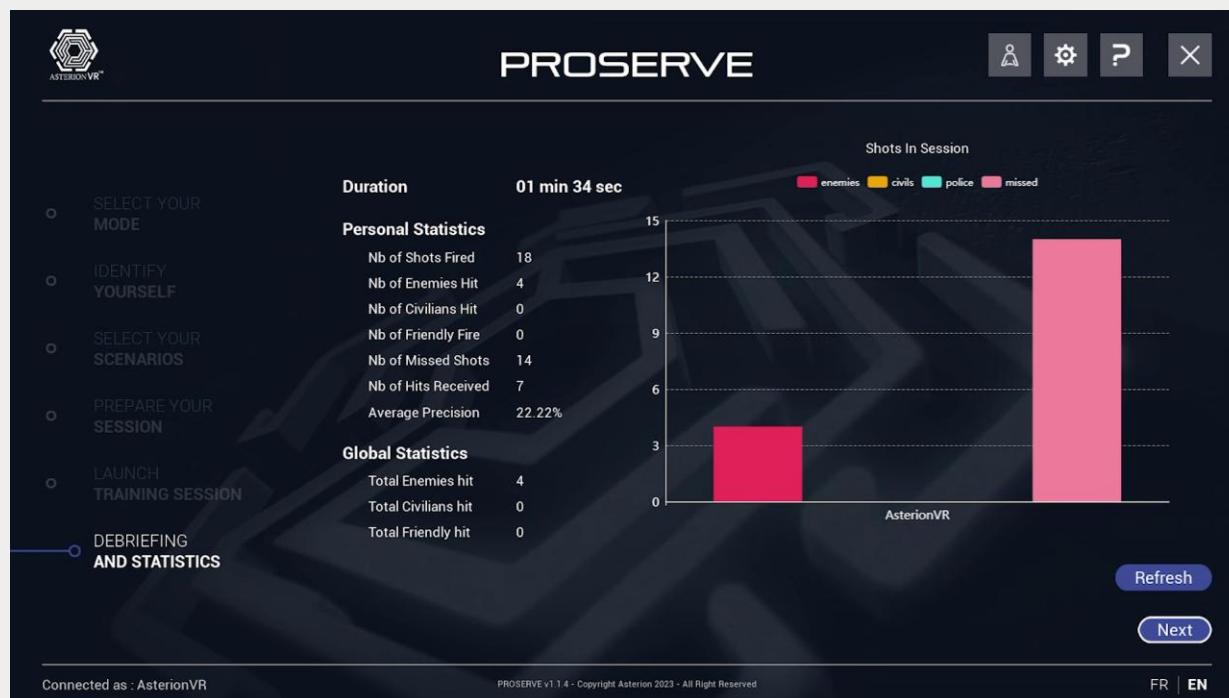

- The "Next" button allows you to change the scenario



ASTERION VR™

Support :

jerome.foucher@asterionvr.com

